



SUMMIT

Manufacturing Corporation

ALUMINUM HIGH PRESSURE HOSE REELS

MANUAL "HAND-CRANK" HOSE REEL



SM SERIES

- 1/2" or 1" Inlet / Outlet Available.
- Stainless Steel Crank Handle With Free Turning Hand Grip.

ELECTRIC "12-VOLT" HOSE REEL



SME SERIES

- 1/2" or 1" Inlet / Outlet Available.
- 1/3 H.P. 12 Volt D.C. Motor.
- Pre-wired Heavy Duty Push Button Switch.
- Solenoid Included & Mounted.

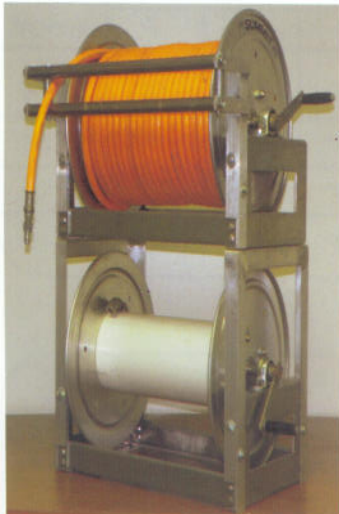

ALUMINUM STACK-KIT

- Stack 2 Hose Reels in a 36" high space.
- Pre-drilled holes, anchor bolts included.
- Manual and Electric reels can be stacked.
- Two piece stack frame is mounted to bottom reel.
- Top reel is mounted to stack frame.

ALUMINUM HOSE-GUIDE

- Keeps hose under control at any angle.
- 4 way roller operation.
- Pre-drilled holes, anchor bolts included.
- Easily mounted.

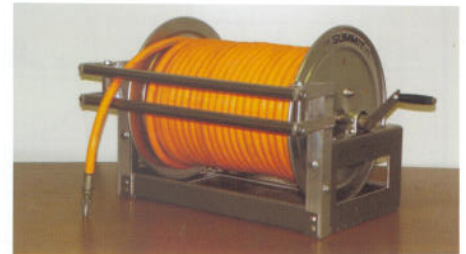

Compare Our Features & Benefits

You'll "Wind Up" With

SUMMIT HOSE REELS

FEATURES & BENEFITS

- Square aluminum frame design generally found only on large Heavy Duty Reels.
- Disc is made of high grade aluminum with rolled edge and strengthening ridge.
- Bolt on spring-loaded locks, for easy field adjustment, or replacement.
- High quality sealed bearings. No lubrication required.
- Adjustable tension spring, keeps hose from free rolling.
- Center drum made with extra thick schedule 80 PVC (stronger than steel).
- Aluminum is corrosion resistant and weighs 35% less than steel reels.
- All Reels are rated at 250° and 3500 PSI operating pressure with Viton seals.
- All Reels are built with the finest quality material available for long lasting service.

MANUAL - SM SERIES

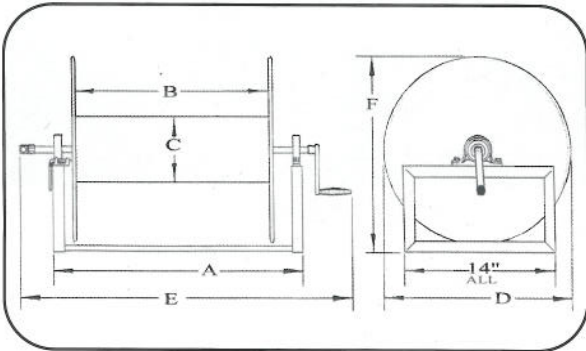

ELECTRIC - SME SERIES

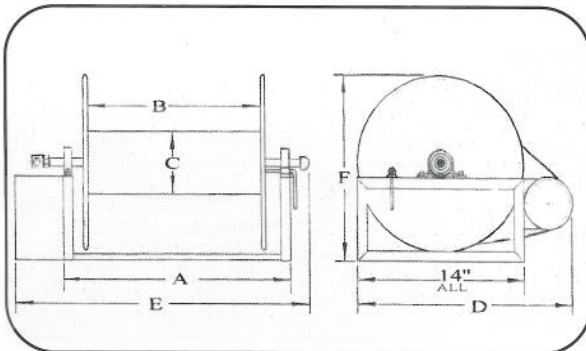

Specifications

Model Number	Reel Dimensions In Inches						Unit Weight
	A	B	C	D	E	F	
SM 12	17"	12"	6"	17"	24"	18"	24 lbs.
SM 15	20"	15"	6"	17"	27"	18"	26 lbs.
SM 18	23"	18"	6"	17"	30"	18"	27 lbs.
SM 22	27"	22"	6"	17"	34"	18"	31 lbs.

Model Number	Reel Dimensions In Inches						Unit Weight
	A	B	C	D	E	F	
SME 12	17"	12"	6"	18"	22"	18"	56 lbs.
SME 15	20"	15"	6"	18"	25"	18"	59 lbs.
SME 18	23"	18"	6"	18"	28"	18"	61 lbs.
SME 22	27"	22"	6"	18"	32"	18"	64 lbs.

Hose Capacity in Feet

SM & SME	1/4" ID	3/8" ID	1/2" ID	5/8" ID	1" ID
12	400'	250'	175'	100'	70'
15	500'	325'	240'	125'	100'
18	600'	400'	300'	150'	125'
22	700'	500'	350'	200'	150'



SUMMIT

Manufacturing Corporation
10586 East 59th Street
Indianapolis, IN 46236

Tel (317) 823-2848

Fax (317) 823-2850

1 - (800) 622-7404